

SEPTEMBER  
2016

# SWIFT CREEK BAPTIST CHURCH

*Connecting with God, Connecting with others, Connecting others with God*

## Connect Group DIRECTORY

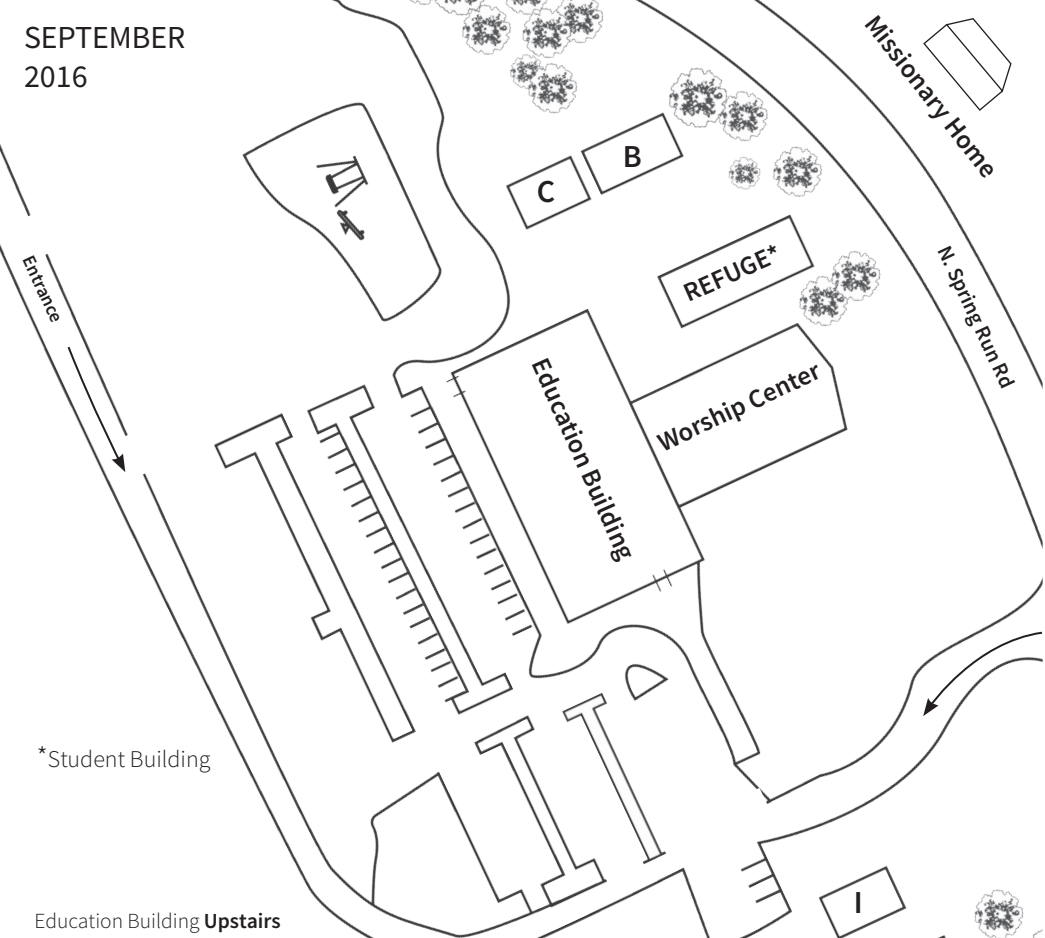

Education Building **Upstairs**

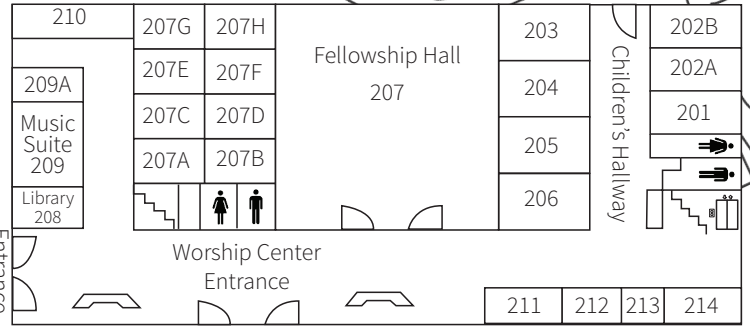

Education Building **Downstairs**

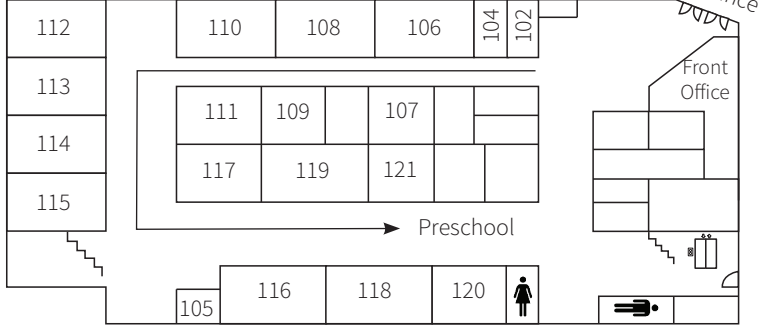

Entrance

**ADULTS**

18-24	College/Career	David Peat	BLDG J-2
25-60	Women	King/Garber	BLDG I-1
30-45	Co-Ed	Tom Powell	Music Suite
30-45	Co-Ed	Jason Hill	BLDG C
30-55	Co-Ed	Chris Moore	BLDG I-2
40-55	Co-Ed	Louis Rogerson	207 F
40-50	Co-Ed	Dave Neudeck	207 E
40-55	Singles	Wiley Easter	BLDG J-1
55-65	Co-Ed	Crowder/Visco/Jennings	207 B, D
45-55	Co-Ed	Carl Turner	Fellowship Hall
60+	Women	Irene Reynolds	207 A

**PRESCHOOL**

Infant I	107
Infant II	109
Toddler I	106
2A	108
2B	110
3A	113
3B	114
4A	119
4B	121
Kindergarten I	116
Kindergarten II	118

**STUDENTS**

Boys 6th	Refuge 2
Boys 7-8th	207 H
Boys 9-10th	207 G
Boys 11th	Refuge 1

**CHILDREN**

1st Grade	205
2nd Grade	204
3rd Grade	203
4th Grade	201
5th Grade	202
Jewels	120
<i>Special Needs</i>	
<i>18 &amp; under</i>	

**Meet in the Refuge at 9:30**

Girls 6th	Refuge 4
Girls 7-8th	Refuge 5
Girls 9th-11	Refuge 3
12th Co-ed	207 C

25-40	Co-Ed	Chris Derry	BLDG C
55-65	Co-Ed	Jerry Keith	Music Suite
70+	Co-Ed	Dickens/Coltrane Sanders/Long	207 E, G
Friends	Special Needs	Loretta Geyer	207 A, B, D
1st-5th Grade	Children's Church	Fellowship Hall	

**8:00 AM**

50-69	Co-Ed	Early Son Risers	207 E
-------	-------	------------------	-------



SWIFTCREEKBAPTIST.ORG

*Listen to the latest sermons*

*Learn about our ministries*

*Read about our beliefs*

7511 NORTH SPRING RUN RD

MIDLOTHIAN, VA 23112

804.739.3001

[Facebook.com/SwiftCreekBaptist](https://www.facebook.com/SwiftCreekBaptist)

**NEED PRAYER?** | PRAYER LINE: 804.739.3001 EXT. 203  
[prayer@swiftcreekbaptist.org](mailto:prayer@swiftcreekbaptist.org)